

Vzpomínky (33)

Město Sherman, Texas, USA

Město pojmenované po hrdinovi texaské revoluce Sidney Shermanovi.

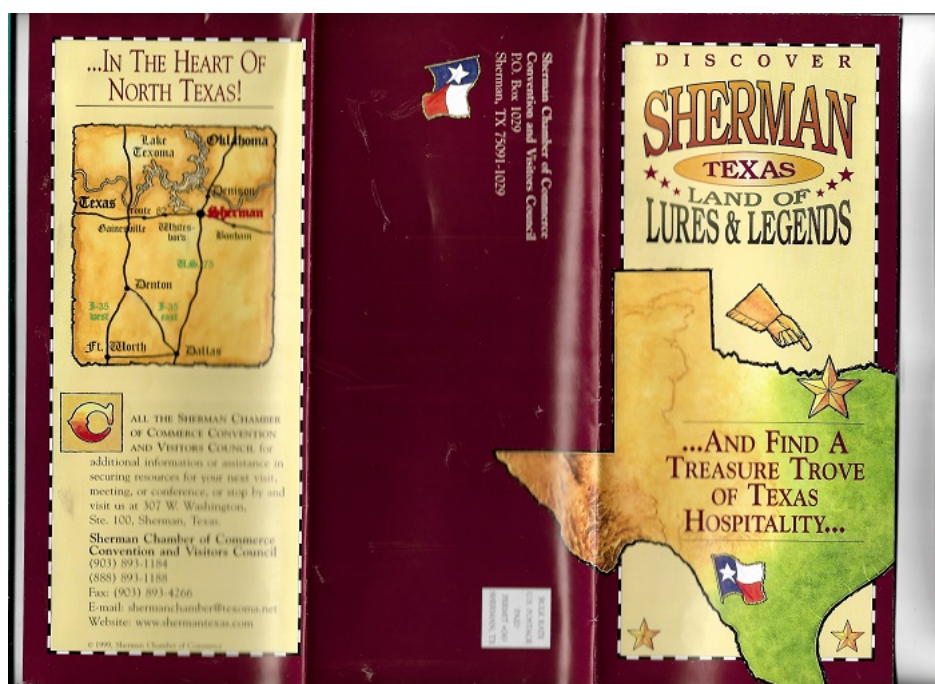

★ EXPLORE THE WEALTH OF OUR RICH HISTORY,
FRIENDLY PEOPLE AND DOWN-HOME FRIENDLY ATMOSPHERE. ★



VOYAGES OF DISCOVERY in Sherman, Texas, means you can load up the car or minivan and begin a trek in any direction without waiting for the tide to rise or the trade winds to blow, which means, you don't always require a small armada of ships and the financial support of royalty.

What makes a trip to Sherman special? You can travel to the past as well as through the present. You can feel the stuff of legends that made Sherman a center of learning, culture and commerce during a time and in a land dominated by railroads, cattle barons, and cotton gins.



You can find innkeepers and merchants whose genuine hospitality is reminiscent of a time when their forebears greeted passengers

on the Butterfield Stage bound for San Francisco or St. Louis.



Sherman is only 20 minutes from beautiful Lake Texoma, one of America's largest lakes. But Lake Texoma is only one of many brilliant gems that will make your treasure hunt in Sherman a memorable adventure.

With a little luck, you'll discover a bountiful trove of people, places and unforgettable moments in Sherman that will leave you far richer for the experience.



There is absolutely no truth to the rumor that Quantrill's Raiders buried a large cache of Civil War gold while bivouacked in Sherman during the autumn of 1863.

TO BEGIN YOUR TREASURE HUNT SIMPLY TURN THE PAGE...



The Lone Star Flag

C. S. Roberts House



EXCITING ATTRACTIONS AND HISTORICAL SITES:

Some Lures and a few Legends...

- 1 **AUSTIN COLLEGE** - 900 N. Grand Avenue. General Sam Houston and Anson Jones, Presidents of the Republic of Texas, served on Austin College's original Board of Trustees. (903) 813-2000.
- 2 **CONFEDERATE MONUMENT** - Courthouse Square. Erected on April 3, 1896, this was the first confederate monument in Texas. (903) 813-4200.
- 3 **GRAYSON COUNTY COLLEGE** - Hwy 691. West campus features public golf course and Munson Viticulture Center. (903) 465-6030.
- 4 **GRAYSON COUNTY FRONTIER VILLAGE** - Loy Lake Road. The village includes a museum and collection of rustic structures from the 19th century. Open mid-May to mid-October. (903) 463-2487.
- 5 **HAGERMAN NATIONAL WILDLIFE REFUGE** - North on FM 1417, 3 miles north of Highway 691, marked by signs. The refuge is a well-documented haven for migrating and wintering waterfowl in the Big Mineral arm of

DISCOVER THE LAND

PLACES TO GO, THINGS TO DO:

More Lures for the strong-willed...

AMUSEMENTS - There are many venues to make you smile including: Grayson County Speedway, Midway Pro Patt Miniature Golf, Peak Performance Driving Range/Batting Cage, Pocket Change Video Arcade, Sher-Den Skate Center, Sherman Go-Karts and Zoli's Billiards.

ANTIQUE SHOPS - Sherman offers an assortment of establishments with a wide range of collections and interests.

FISHING - With Lake Texoma 20 minutes away, need we say more? Yes, we need to mention that Pickens Lake in Baker Park, inside city limits, and Loy Lake make angling even more convenient.

GOLF COURSES - Several outstanding courses are available, and greens fees are reasonable.

HILLCREST PARK - This is a small park constructed primarily for handicapped children near Wilson N. Jones Hospital, 1215 Hillcrest Dr.

HISTORICAL DRIVING TOUR - Brochures are available at the Chamber of Commerce, which detail more than 70 historical spots around Sherman.

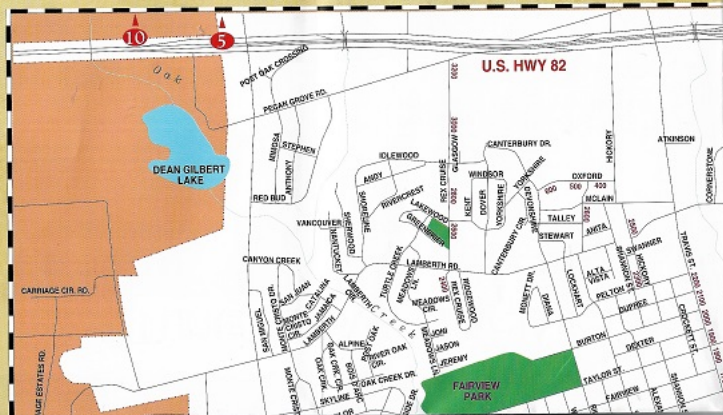

OF LURES & LEGENDS...

Mockingbird
The State Bird of Texas



HORSEBACK RIDING - There are ample opportunities to enjoy riding trails at Tanglewood on Lake Texoma and elsewhere.

JOGGING TRAILS - There are walking and jogging trails around Fairview Park and Haven Park within minutes of Texoma Parkway.

LAKE TEXOMA - Picnic spots, boat charters and fishing guides all available on this big, beautiful lake. Lake Texoma Association, (580) 564-2334.

MORE MUSEUMS - Harber's Wildlife Exhibit, American Bank, (903) 892-2181, Museum of American Victorian Furniture, 201 E. Lamar, (903) 893-5033.

SHOPPING - A variety of shopping centers and malls provide a plethora of shops and dining establishments. They include:

- Canyon Creek Center, 2121 FM 1417;
- Jamestown Plaza, 1916 North Grand Ave.;
- Kam Korner, 1000 North Travis;
- Kelly Square, 115 South Travis;
- Loy Lake Plaza, 1800 Loy Lake Road;
- Midway Mall, 4800 Texoma Parkway;
- Oak Glen Shopping Center, 1600 Texoma Parkway;
- Parkway Village, 1700 Texoma Parkway;
- Shannon Heights, 1800 North Travis;



- Sher-Den Mall, 3201 Texoma Parkway;
- Sherman Antique Mall, 221 S. Travis;
- Southwood, 100 South Woods;
- Taylor Plaza, 2000 Loy Lake;
- Texoma Crossing, 2700 Hwy 75;
- Texoma Place, 2200 Texoma Parkway;
- Touch of Class Antique Mall, 118 W. Lamar;
- Westwood Village Shopping Center, 220 Sunset.

SWIMMING - There are two public swimming pools in Sherman: Fairview Park on West Tylee, and Haven Park on Dewey Avenue.

TENNIS COURTS - Public tennis courts are located at Fairview Park, West Taylor Street; Cherry Street Park, South Grand Avenue; and Belker Park East Pecan.

THEATERS - There are plenty of movie screens, which usually means no waiting to see the latest films:
 Movies 7, 2510 Texoma Parkway, (903) 892-2311;
 Movies 5, Midway Mall, 4800 North Texoma Parkway, (903) 893-3191;
 For live drama: Finley Playhouse, 503 North Elm, (903) 892-8818, has provided local community.

YOU'LL DISCOVER MORE ON HISTORIC HIGHWAYS:

North on U.S. 75
 Dwight D. Eisenhower's Birthplace, Denison, Texas
 Dwight D. Eisenhower, 34th president of the U.S.
 (703) 406-1111, (800) 451-7000, (703) 406-1111

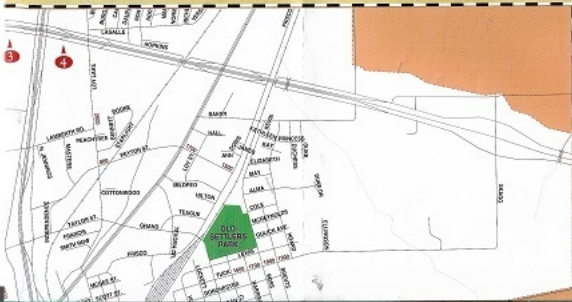

6 HERITAGE ROW OF HOMES - 300 to 1300 blocks of South Crockett. This neighborhood offers visitors an architecturally rich enclave of restored Victorian-style homes to enjoy.

7 MARCY'S BUTTERFIELD RAIL CROSSING - 404 W. Washington. Historical site marks Marcy's California Trail (1849) and Butterfield Stage Trail (1858).



8 MARTIN LUTHER KING, JR. MONUMENT - This monument dedicated to the black civil rights leader is located at the Martin Luther King, Jr. Memorial Park on East Street.

9 R.D. SHERMAN OFFICE HOUSE - 300 North Travis. Originally a three-story Victorian structure with ornate details, this historic building was remodeled in 1961 for commercial purposes.

10 BERTON CEMETERY Located on Preston Parkway at Lake Texoma, the cemetery marks the graves of William Coffee and Sophia Berton. A granite marker commemorates the Indian Trade Post established by Coffee in 1811.

11 RED RIVER HISTORICAL MUSEUM - 301 S. Walton. The museum is housed in the former Carnegie Library, built in 1914 and recorded in the National Register of Historic Places. Visitors will enjoy a variety of exhibits.

12 ROBERTS HOUSE - 515 S. Crockett. One of the beautiful antiques home and quaint porch situated in the Preservation League.



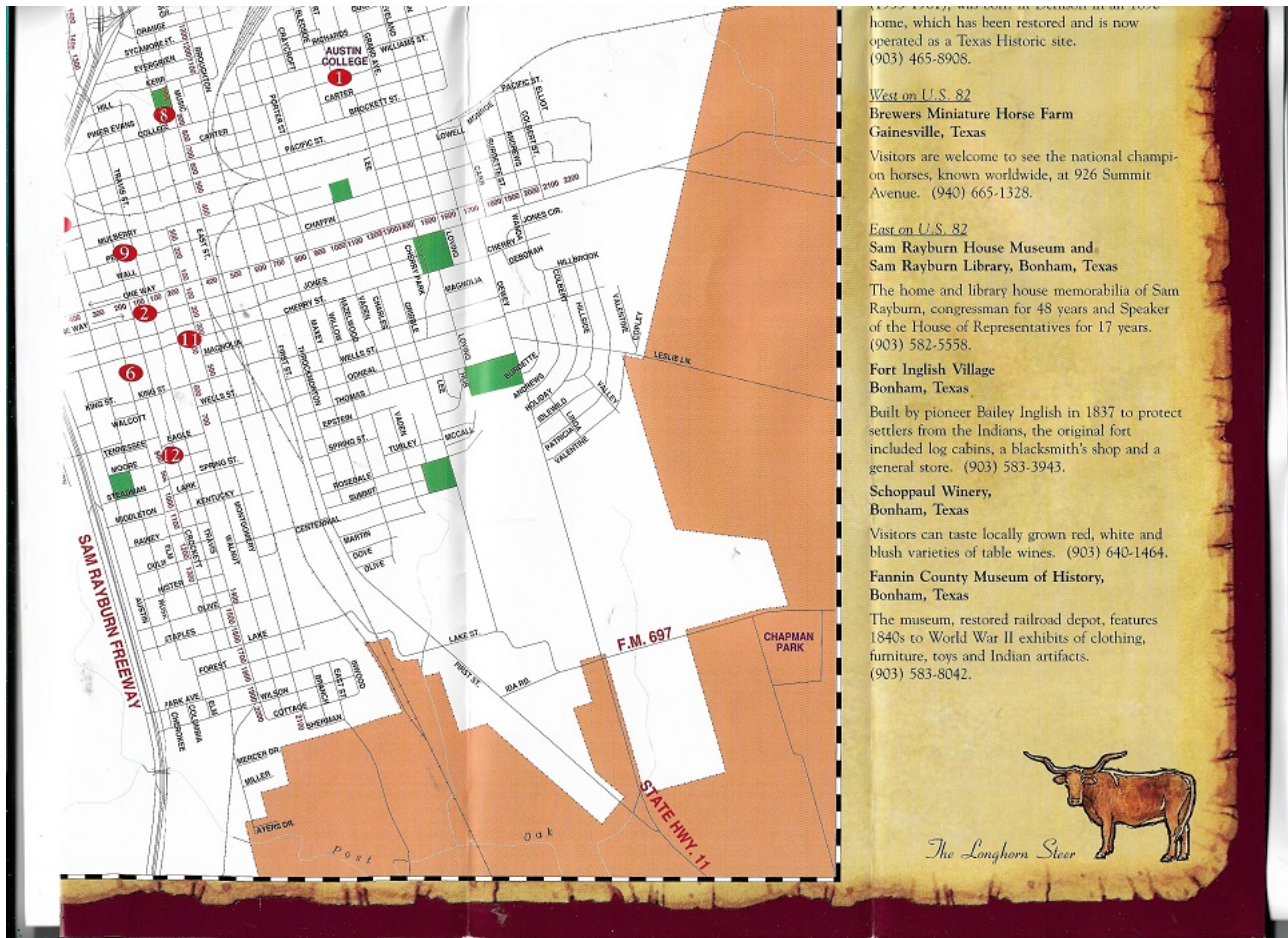

Zdroj: Soukromá sbírka propagačních materiálů USA IL - Materiál získaný od Sherman Chamber of commerce SHERMAN